

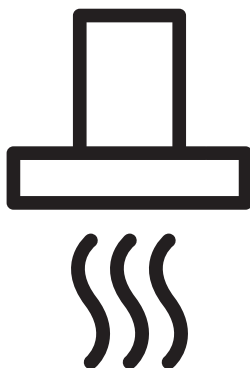

Cooker Hood

User Manual



HCA62640WH HCA92640WH
HCA62640BH HCA92640BH
HCA62540B HCA92540B

EN - DE - ES - FR - PL - NL - CS - IT - SL - SK - UA - RU - RO - PT - LT - LV - ET -
DA - NO - SV - FI - EL - HR - HU - SR



01M-8848773200-1522-13
01M-8848783200-1522-13
01M-8851123200-1522-13

01M-8848793200-1522-13
01M-8848803200-1522-13
01M-8851313200-1522-13

CONTENTS

ENGLISH	3-18
DEUTSCH	19-36
ESPAÑOL	37-54
FRANÇAIS	55-71
POLSKI	72-90
NEDERLANDS	91-106
ČESKY	107-122
ITALIANO	123-138
SLOVENŠČINA	139-154
SLOVENSKÝ	155-170
УКРАЇНСЬКА	171-193
РУССКИЙ	194-217
ROMÂNĂ	218-237
PORTUGUÊS	238-255
LIETUVIŲ K	256-271
LATVIEŠU	272-287
EESTI	288-303
DANSK	304-319
NORSK	320-335
SVENSKA	336-351
SUOMI	352-365
ΕΛΛΗΝΙΚΑ	366-385
HRVATSKI	386-401
MAGYAR	402-417
СРПСКИ	418-437

Please read this user manual first!

Dear Valued Customer,

Thank you for preferring this Beko appliance. We hope that you get the best results from your appliance which has been manufactured with high quality and state-of-the-art technology. For this reason, please read this entire user manual and all other accompanying documents carefully before using the appliance and keep it as a reference for future use. If you handover the appliance to someone else, give the user manual as well. Follow the instructions by paying attention to all the information and warnings in the user manual.

Remember that this user manual may also apply to other models. Differences between models are explicitly described in the manual.

Meanings of the Symbols

Following symbols are used in various sections of this user manual:



Important information and useful hints about usage.



WARNING: Warnings against dangerous situations concerning the security of life and property.



WARNING: Warning for danger of fire.



WARNING: Warning for electric shock.



This appliance has been produced in environmentally friendly facilities without harming the nature.

1 Important safety and environmental instructions

1.1 General Safety

Important Safety Instructions
Read Carefully And Keep For Future Reference This section contains safety instructions that will help protect from risk of fire, electric shock, exposure to leak microwave energy, personal injury or property damage. Failure to follow these instructions shall void any warranty.

- Beko products comply with the applicable safety standards; therefore, in case of any damage on the appliance or power cable, it should be repaired or replaced by the dealer, service center or a specialist and authorized service alike to avoid any danger. Faulty or unqualified repair work may be dangerous and cause risk to the user.
- This appliance is intended to be used in household and similar applications such as:
 - Staff kitchen areas in shops, offices and other working environments;
 - Farm houses
 - By clients in hotels, and other residential type environments;
 - Bed and Breakfast type environments.
- Operate the appliance for its intended purpose only as described in this manual.
- The manufacturer cannot be held liable for damages resulting from improper installation or misuse of the product.
- This appliance can be used by children aged from 8 years and above and persons with reduced physical, sensory or mental capabilities or lack of experience and knowledge if they have been given supervision or instruction concerning use of the appliance in a safe way and understand the hazards involved.
- Children shall not be allowed play with the appliance. Cleaning and user maintenance shall not be made by children without supervision.

1 Important safety and environmental instructions

- The minimum distance between the supporting surface for the cooking vessels on the hob and the lowest part of your product must be at least 65 cm.
 - If the instructions for installation for the gas hob specify a greater distance, this has to be taken into account.
 - Make sure that your mains power supply complies with the information supplied on the rating plate of the appliance.
 - Never use the appliance if the power cable or the appliance itself is damaged.
 - Prevent damage to the power cable by not squeezing, bending, or rubbing it on sharp edges. Keep the power cable away from hot surfaces and naked flame.
 - Use the appliance with a grounded outlet only.
- WARNING:** Do not connect the appliance to the mains until the installation is fully complete.
- Place the appliance in a way so that the plug is always accessible.
 - Do not touch the lamps if they have operated for a long time. They can burn your hands since they will be hot.
 - Follow the regulations set out by competent authorities on discharge of the exhaust air (this warning is not applicable for use without flue).
 - Operate your appliance after putting a pot, pan etc. on the hob. Otherwise, high heat may cause deformation in some parts of your product.
 - Turn off the hob before taking the pot, pan etc. from it.
 - Do not leave hot oil on the hob. Pans with hot oil may cause self combustion.
 - Pay attention to your curtains and covers since oil may catch fire while cooking food such as fries.
 - Grease filter must be cleaned at least monthly. Carbon filter must be replaced at least every 3 months.

1 Important safety and environmental instructions

- Product shall be cleaned accordance with user manual. If cleaning was not carried out in accordance with user manual, there may be fire risk.
 - Do not use non-fire-resistant filtering materials instead of the current filter.
 - Only use the original parts or parts recommended by the manufacturer.
 - Do not operate the product without the filter and do not remove the filters while the product is running.
 - In the event of be started any flame, de-energize your product and cooking appliances.
 - In the event of be started any flame, cover the flame and never use water to extinguish.
 - Unplug the appliance before each cleaning and when the appliance is not in use.
 - The negative pressure in the environment should not exceed 4 Pa (4x10 bar) while the hood for electric hob and appliances running on another type of energy but electricity operate simultaneously.
 - In the environment where the appliance is being used, the exhaust of devices running on fuel oil or gas, such as room heater must be absolutely isolated or device must be hermetical type.
 - When connecting the flue, use pipes with a diameter of 120 or 150 mm. Pipe connection must be as short as possible and have as few elbows as possible.
- Danger of choking!** Keep all the packaging materials away from children.
- CAUTION:** Accessible parts may become hot when used with cooking appliances.
- The product outlet must not be connected to air channels that include other smoke.
 - The ventilation in the room may be insufficient when the hood for electric hob is used simultaneously with the devices operating on gas or other fuels (this may not apply to appliances that only discharge the air back into the room).

1 Important safety and environmental instructions

- Objects placed on the product may fall. Do not place any objects on the product.
- Do not flambe under the your product.

WARNING: Before installing the Hood, remove the protective films.

- Never leave high naked flames under the hood when it is in operation
- Deep fat fryers must be continuously monitored during use: overheated oil can burst into flames.

1.2 Compliance with the WEEE Directive and Disposing of the Waste Product:

This product complies with EU WEEE Directive (2012/19/EU). This product bears a classification symbol for waste electrical and electronic equipment (WEEE).

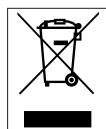

This symbol indicates that this product shall not be disposed with other household wastes at the end of its service life. Used device must be returned to official collection point for recycling

of electrical and electronic devices. To find these collection systems please contact to your local authorities or retailer where the product was purchased. Each household performs important role in recovering and recycling of old appliance. Appropriate disposal of used appliance helps prevent potential negative consequences for the environment and human health.

1.3 Compliance with RoHS Directive

The product you have purchased complies with EU RoHS Directive (2011/65/EU). It does not contain harmful and prohibited materials specified in the Directive.

1.4 Package Information



Packaging materials of the product are manufactured from recyclable materials in accordance with our National Environment Regulations. Do not dispose of the packaging materials together with the domestic or other wastes. Take them to the packaging material collection points designated by the local authorities.

2 General appearance

2.1 Overview

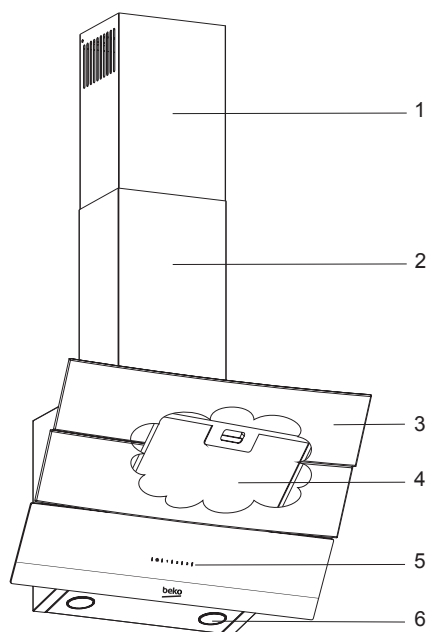

1. Inner chimney
2. Outer chimney
3. Glass cover
4. Grease filter (Behind Glass Cover)
5. Control panel
6. Lighting

2 General appearance

2.2 Technical data

	HCA62640WH HCA62640BH	HCA62540B	HCA92640WH HCA92640BH	HCA92540B
Width	596 mm		896 mm	
Depth	386 mm		393 mm	
Height	750/1080 mm		750/1130 mm	
Supply voltage & frequency	220-240V ~, 50 Hz			
Control	With 3 levels			
Lamp power	2x3 W			
Air outlet pipe	120/150 mm			
Flow rate – 3. Level	537 m³/h	566 m³/h	577 m³/h	593 m³/h
Motor power	210 W			
Total power	216 W			
Insulation class of motor	Class F			
Insulation class	Class I			

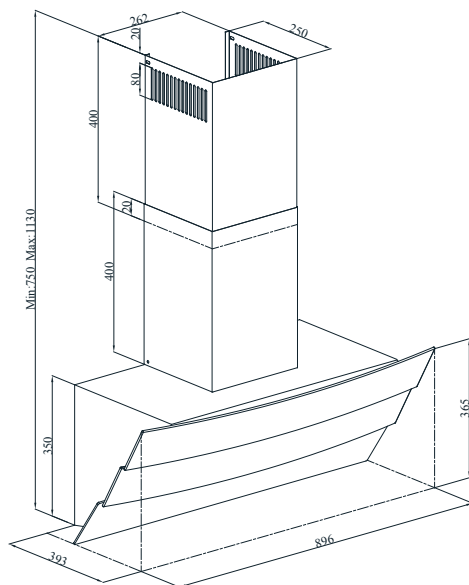

**HCA92640WH
HCA92640BH
HCA92540B**

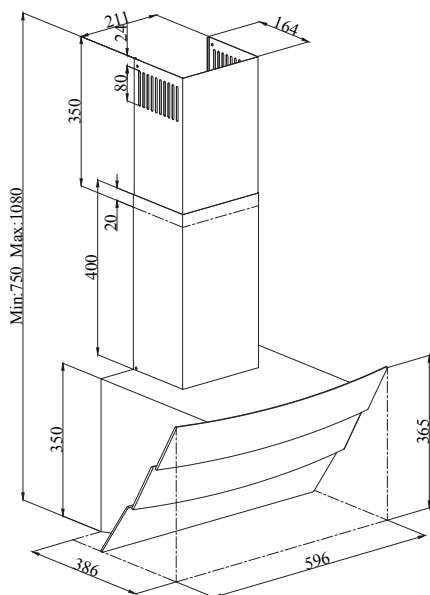

**HCA62640WH
HCA62640BH
HCA62540B**

3 Operation of the appliance

3.1 Controlling the appliance

<div><div> </div><div>✱</div><div> </div><div>1</div><div> </div><div>2</div><div> </div><div>3</div><div> </div></div> <div><div>A</div><div>B</div><div>C</div><div>D</div></div>	
KEY	FUNCTION
A : Light On / Off	You may illuminate the cooking area by pressing this button. Re-press the button to turn off the lamp.
B : 1. Stage Button	Operates the appliance on 1st speed. When you press this button again to turn off the appliance, the screen speed stage turns off.
C : 2. Stage Button	Operates the appliance on 2nd speed. When you press this button again to turn off the appliance, the screen speed stage turns off.
D : 3. Stage Button	Operates the appliance on 3rd speed. When you press this button again to turn off the appliance, the screen speed stage turns off.

3.2 Efficient use in terms of energy saving

- When using your appliance, adjust the speed settings according to vapour and odour intensity, in order to save energy.
- Use low speeds (1-2) under normal conditions, and high speed (3) for intense odour and vapour.
- The lamps on the hood are placed for illuminating the cooking area.
- Using them for environmental lighting shall cause unnecessary energy expenditure and insufficient lighting.

3.3 Operation of the hood

- Your appliance contains a motor that has various speeds.
- For better performance, we recommend using low speeds under normal conditions and high speeds in cases of strong odours and intense

vapour.

- You can start your appliance by pressing on the desired speed setting button. (B,C,D)
- You can illuminate the cooking area by pressing the lamp. (A)

3.4 Auto-stop in 15 min.

This appliance is equipped with an Auto-Stop function which allows the appliance to ventilate the room for an additional period of time in order to remove the unpleasant odour and vapour in the room after the cooking is over. Appliance stops automatically after a certain period of time. To enable the Auto-stop function, press any of the speed level keys (B, C, D) on the control for longer than 2 seconds. A timer with 15 minutes will be activated. If you press the same speed level key while the Auto-stop function is enabled, function will be disabled and the appliance will stop. If you select a different speed level this function will be disabled. If you want your appliance to stop automatically, you must enable the Auto-stop function again.

Periodical cleaning of metal filters

Filters must be cleaned at about every 60 hours of operation or 4 weeks depending on the frequency of usage.

3.5 Replacing the lamps

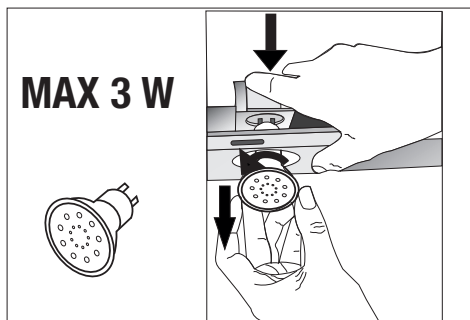

3 Operation of the appliance

Disconnect the hood from the mains supply. This appliance is equipped with 3 W halogen lamps. To replace the halogen lamps, press the lamp downwards from the rear section of the lamp holder to release the lamp. Then turn it counterclockwise by 1/4 tour and remove it. Perform the above steps in reverse order to fit the new lamps.



You may procure lamps from Authorised Service Agents.

Bulb	
Bulb Power	3 W
Holder / Socket	GZ 10
Bulb Voltage	220 - 240 V
Size	53 x 50 mm
ILCOS Code	DR/F3-220-240-GZ10-50-53
Luminous flux	260 lm
Correlated colour temperature	3000 K

This product contains a light source of energy efficiency class “F”.

3.6 Operation with chimney connection

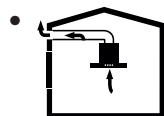

Vapour is extracted through the flue duct, which is fastened to the connection head on the hood.

- The diameter of the flue duct must be the same as the connection ring. In horizontal settings, the pipe has to have a slight upward slope (around 10°) so that the air can exit the room easily.

3.7 Operation without chimney connection

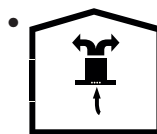

Air is filtered through the carbon filter and recirculated in the room. Carbon filter is used when it is impossible to use a flue in the house.

- In flueless use, remove the flaps inside the flue adapter.
- Remove the Grease filter. To install the carbon filter, fit the filter to the tabs by centring it on the plastic piece on both sides of the fan body. tighten it by turning right or left.
- Replace Grease filter.

4 Cleaning and maintenance



Before cleaning and maintenance, unplug the product or turn off the switch.

4.1 Cleaning of the grease filter

Grease filter retains the oil particles in the air. Grease filters may change colour after repeated cleaning. This is normal and does not require replacement of filters.

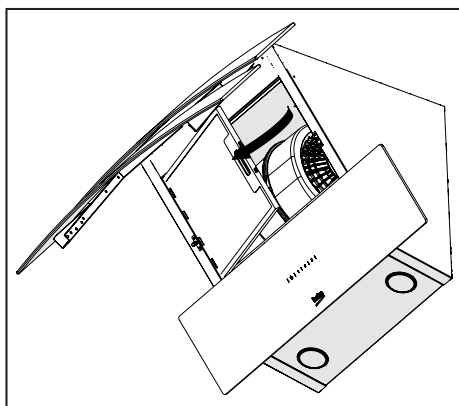

- Push the grease filter lock forward.
- Then pull it slightly down and pull it out. Otherwise, you can bend the filter. Wash and rinse grease filters with liquid detergent and replace grease filters to their sockets by carrying out the steps specified above in reverse order. This filter retains the oil particles in the air.



You may wash your grease filters in the dishwasher.



CAUTION: In case of normal use, clean your filter once in a month.

4.2 Replacement of carbon filters

Odour removing filters contain charcoal (Active carbon). Grease filters must be installed in the product, regardless of whether or not carbon filters are used.

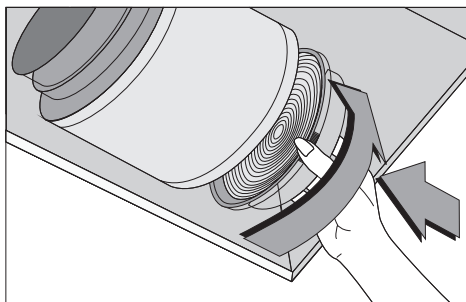

- Remove the grease filter.
- To remove the carbon filter, remove the carbon filter from its housing by rotating it counter-clockwise from the tab.
- Install the new carbon filter.
- Install the grease filter.

CAUTION



- Carbon filter shall never be washed.
- Replace carbon filters once every 3 months.
- You can obtain the carbon filter from the authorized services.

5 Installation of appliance



WARNING: Before starting the installation, read the safety information on user manual.



WARNING: Failure to install with screws and stabilizers in accordance with these instructions may result in electric shock.

For the installation of the hood, please contact the nearest Authorized Service.

It is the customer's responsibility to prepare the location and electrical installation of the hood.

5.1 Position of the appliance

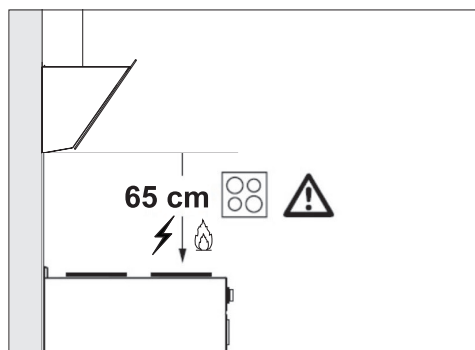

- Distance between the cooker and the cooker hood must be considered prior to assembly. This distance should be 65 cm.
- Distance must be measured from the surface of grate for gas cookers,
- from surface of glass for electric cookers.

5.2 Installation accessories

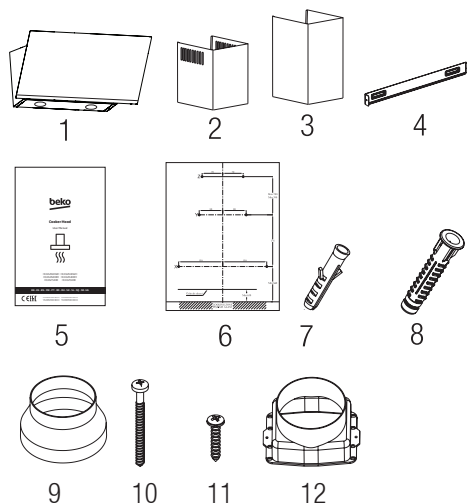

1. Product
2. Inner Chimney
3. Outer Chimney
4. Chimney Connection Plate
5. User Manual
6. Assembly Pattern
7. Ø6mm Plastic Dowel
8. Ø8mm Plastic Dowel
9. 150/120mm Plastic Chimney Adapter
10. 4.9x50 Cross-head screw
11. 3.9x22 Cross-head screw
12. Ø150 mm plastic flue

Information required for the preparation of the installation place for your hood is given below.

5.3 Installing the hood onto the wall

To install the hood onto the wall, loosen the screws of hanger plates on the motor housing and pull the plates upwards. Then, tighten the screws of the hanger plates. (Figure 1a).

5 Installation of appliance

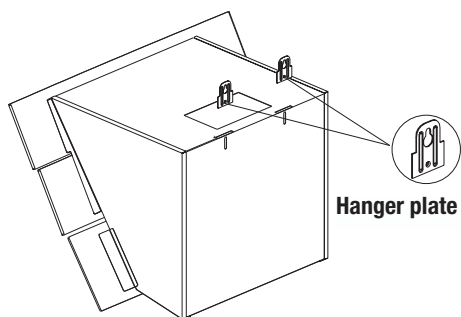

(Figure 1a-60)

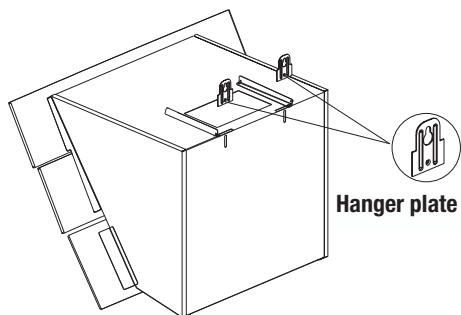

(Figure 1a-90)

External flue connection plate

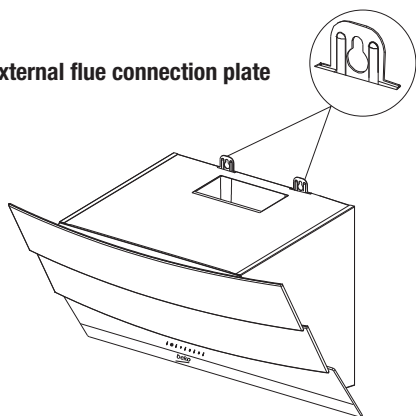

(Figure 1b-60)

External flue connection plate

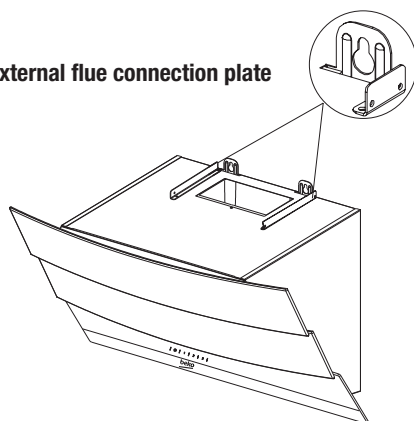

(Figure 1b-90)

Secure the 150 mm plastic flue adapter onto the top of the body with 3.5x9.5 screw included in installation accessories (Figure 2).

If you will use Ø 120 mm flue pipe, install Ø 120 mm flue adapter onto it.

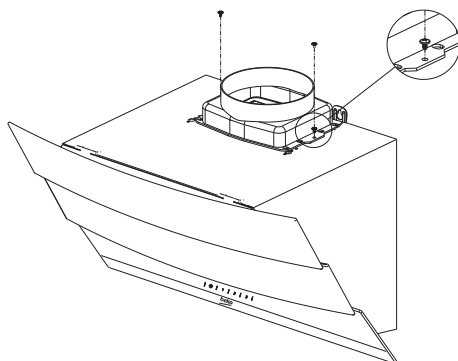

(Figure 2-60)

5 Installation of appliance

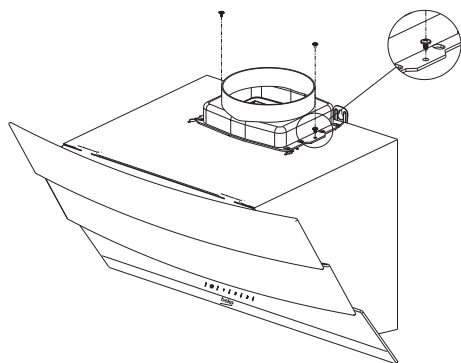

(Figure 2-90)

5.4 Boring the hanger holes

Affix the installation template onto the installation place of the hood. Drill the points marked with (X,Y) using a $\varnothing 8$ mm bit and points marked with (Z) using a $\varnothing 6$ mm bit. (Figure 3)

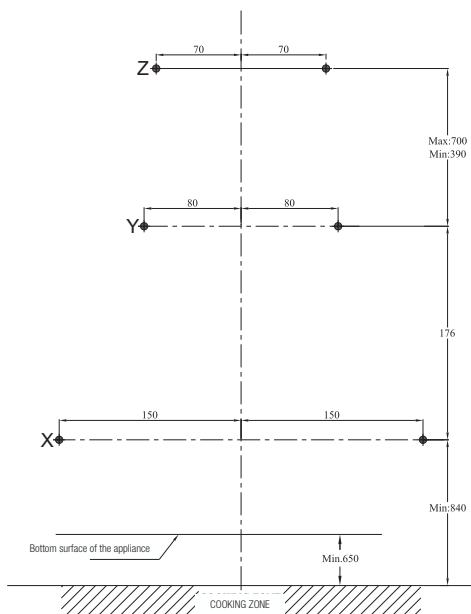
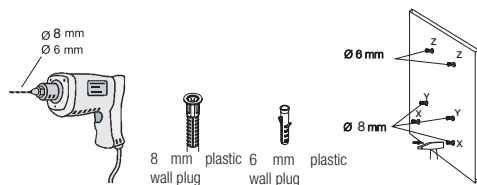

(Figure 3)

5.5 Hammering the wall plugs

Hammer $\varnothing 8$ mm wall plugs (X,Y) into the holes drilled for hanger screws. Hammer 2 x $\varnothing 6$ mm wall plugs (Z) into the holes drilled with a $\varnothing 6$ mm bit for the external flue connection plate. (Figure 3)

5.6 Installing the hanger screws

Install 4.9x50 hanger screws into the $\varnothing 8$ mm wall plugs (Y) you have hammered into the wall. There must be a gap of 5 mm between the screw head and the wall. Connect the internal flue connection plate to the 8 mm wall plugs (Z) on the wall using $\varnothing 3.9 \times 22$ screws. (Figure 4)

5 Installation of appliance

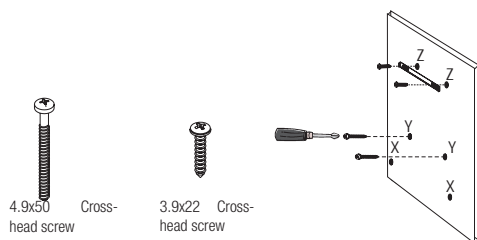

(Figure 4)

5.7 Hanging the hood onto the wall

- Hang the hood onto the screws you have installed into the Y holes.
- Open the side suction window of the hood by pulling it towards yourself. Install the 4.9x50 screws through the X holes located inside in order to secure the appliance.

5.8 Installing the hood flue

Disconnect the product from mains supply before starting flue installation. Fit the sheet metal flue parts around the body.

Screw the external flue to the external flue connection plates located on the motor housing. (Figure 1b/5)

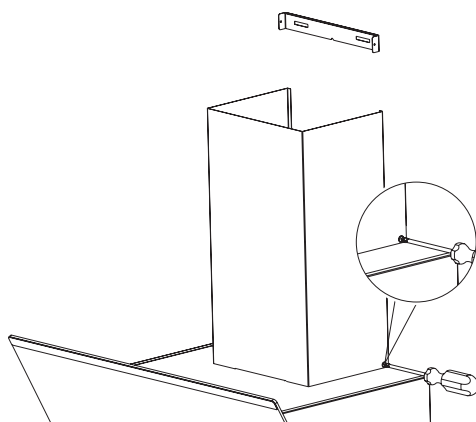

(Figure 5)

Extend and screw the internal flue from its outer edges onto the flue connection plate which was secured to the wall (Figure 6).

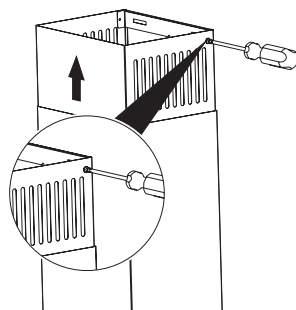

(Figure 6)

5.9 Flue connection

Place adapter supplied together with the hood into the ventilation hole located on the top section of the hood. Procure a pipe with a diameter of 120/150 mm. Connect one end of the pipe to the adapter and the other end to the flue. Make sure that these two connections are secure enough so that they will not dislocate when the hood is operated in max. speed. Check that the flaps inside flue are functional when tightened with the clamp. Fit the flue connection pipe onto the adapter. If you fit the flue connection pipe inside the adapter, air suction will not occur since the flaps that prevent air backflow will remain closed. It is not advisable to make connections to the flues connected with stoves or exhaust shafts. Do not make connections to such flues. Pipe connection must be as short as possible and have minimum number of elbows.

A: Flue outlet pipe

B: Flaps that prevent backflow

C: Plastic flue

5 Installation of appliance

5.10 Backflow prevention system (N-RV)

When the hood is operated, flaps are closed in order to prevent possible odours and dust from entering into the ambient from outside.

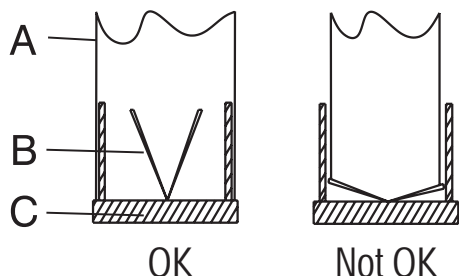

5.11 Storage

- If you do not intend to use the appliance for a long time, please store it carefully.
- Please make sure that the appliance is unplugged, cooled down and totally dry.
- Store the appliance in a cool and dry place.
- Keep the appliance out of the reach of children.

5.12 Handling and transportation

- During handling and transportation, carry the appliance in its original packaging. The packaging of the appliance protects it against physical damages.
- Do not place heavy loads on the appliance or the packaging. The appliance may be damaged.
- Dropping the appliance will render it non-operational or cause permanent damage.

6 Troubleshooting

Troubleshooting	Root Cause	Help
Appliance is not working.	Check your fuses.	Fuse may be blown, inspect and restore it.
Appliance is not working.	Check the electrical connection.	Mains voltage shall be between 220 and 240 V.
Appliance is not working.	Check the electrical connection.	Check if other appliance in your kitchen operate.
Illumination light does not operate.	Check the electrical connection.	Mains voltage shall be between 220 and 240 V.
Illumination light does not operate.	Inspect the lamp switch.	Lamp switch shall be at "on" position.
Illumination light does not operate.	Inspect the lamps.	The lamps of the appliance shall illuminate.
Air inlet of the appliance is inadequate.	Inspect the grease filter.	Under normal operating conditions, grease filter shall be cleaned at least once in a month.
Air inlet of the appliance is inadequate.	Check the air discharge flue.	The air discharge flue shall be at "on" position.
Air inlet of the appliance is inadequate.	Inspect the carbon filter.	The filters of the appliances with carbon filters shall be replaced once in every 3 months under normal conditions.